

VISOR ASSEMBLY (TYPE 2)

REF: E058-0 08-11-06

INSTALLATION INSTRUCTIONS

ASSEMBLY:

The visor is supplied with fixing screws, washers and hexagon drive keys.

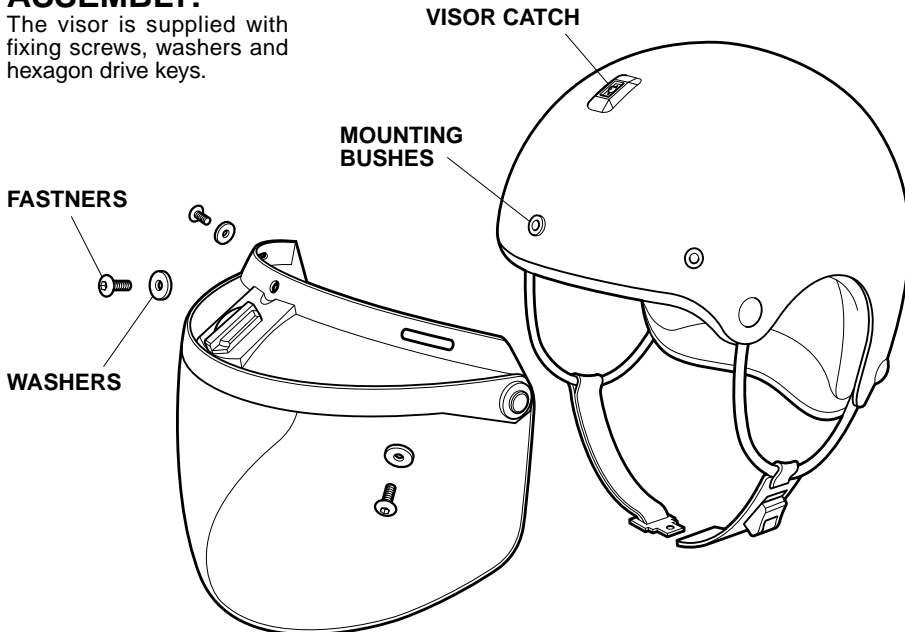

NOTE:

Visor Catches are only fitted to helmets manufactured since 2006.

1. Position the visor in relation to the mounting bushes taking care not to cross-thread the screws.
2. Fasten the visor securely in place.

3. If necessary, adjust the position of the visor catch on the helmet so that it holds the visor in the open position.

If there is insufficient adjustment available by moving the visor catch only, release the two outermost visor fixing screws, move both sides of the visor up or down and re-tighten the fixing screws whilst holding the visor in position.

IMPORTANT

READ THIS INFORMATION CAREFULLY BEFORE ATTEMPTING TO USE THIS ITEM OF EQUIPMENT